

# OPAL

TWO -STOREY

TOTAL : 1748 SQ. FT.

WIDTH : 26'



**FRONT ELEVATION**

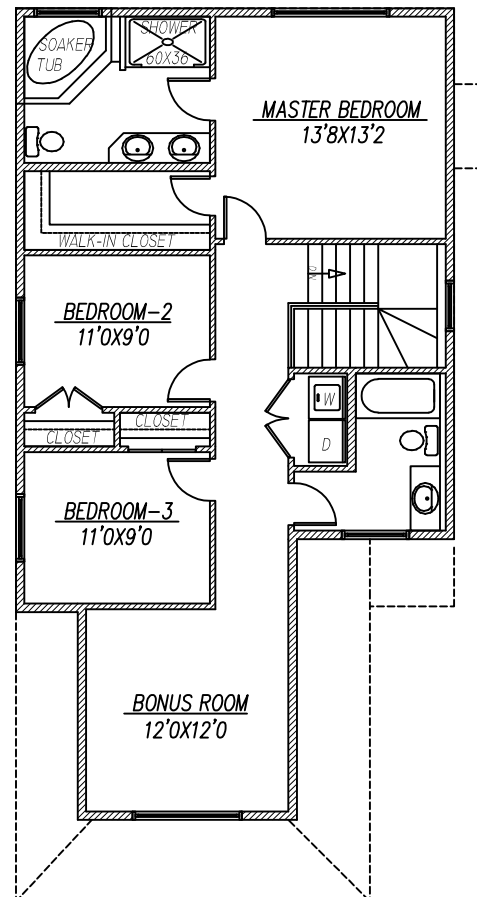
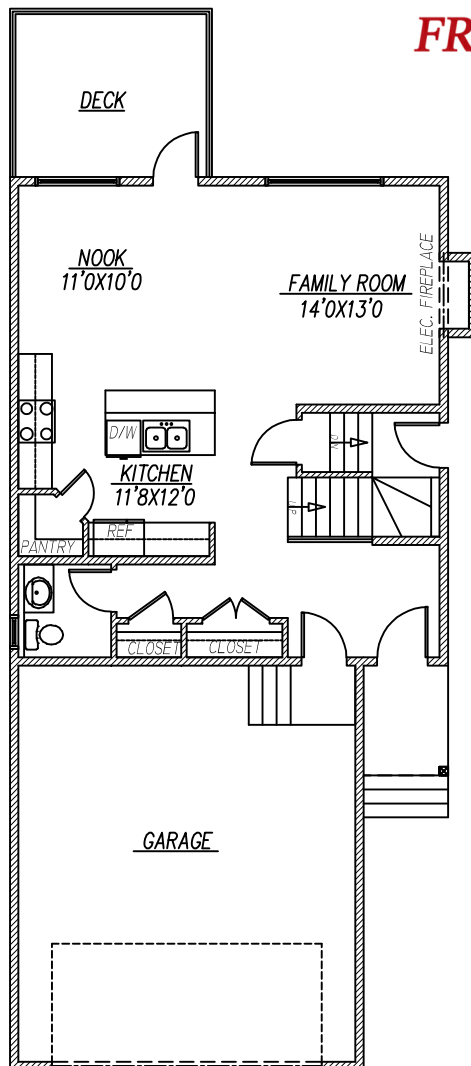

[www.victoryhomescanada.com](http://www.victoryhomescanada.com)

**MAIN FLOOR 763 SQ. FT.**

**UPPER FLOOR 985 SQ. FT.**

For further information please contact our office at 780-395-9191  
FLOOR PLANS, SPECIFICATIONS AND DIMENSIONS SHOWN ARE APPROXIMATE AND SUBJECT TO CHANGE WITHOUT NOTICE.